

M Series Residential

Turtle Friendly Downlighting System

4" Round



Project:	Type:
Product Code:	Date:

TF

- Turtle Friendly** Compliant with guidelines to minimize lighting's impact on sea turtles
- Quick Install** Integrated driver and plug-and-play connection require no wiring
- High Performance** Precise lighting control without sacrificing stellar efficiency
- Enhanced Dimming** Smooth, flicker-free dimming down to 1%

OPTICAL

Module

Fixed

Delivered Lumens (Power)

400 lm (12W)

Wavelength

> 560 nm

Color Temperature

Turtle Friendly

Beam Spread

- | | |
|-------------------|----------------|
| Narrow Spot (15°) | General (90°+) |
| Spot (25°) | Linear |
| Flood (40°) | Soft Focus |
| Wide Flood (60°) | |

PHYSICAL

Aperture

4"

Application

New Construction, Remodel

Shape

Round

Ceiling Thickness

1/2" up to 1 3/4" (New Construction)
5/8" up to 1 1/4" (Remodel)

TRIMS

Aperture

4"

Shape

Round, Square Conversion

Style

Beveled, Hyperbolic, Pinhole, Wall Wash, Flangeless, Dead Front

Finish

White, Black, Bronze, Clear Diffused, Warm Diffused, Custom

ELECTRICAL & CONTROLS

Input Voltage

120 / 277V

1% Dimming

TRIAC/ELV, 0-10V

RATINGS

Housing

- IC (Insulation Contact) Rated
- ASTM E283 Certified Air Tight
- Code compliant for use in fire-rated assemblies up to a maximum of 2-hours
- STC/IIC Sound Rated
- Chicago Plenum

Module and Trim

- UL Listed for Wet Location



Declare.





PRODUCT BUILDER

M SERIES HOUSING

PRODUCT CODE		APPLICATION		SHAPE		RATING	
<input type="text"/>		<input type="text"/>		<input type="text"/>		<input type="text"/>	
M4	4" Housing	NC	New Construction	R	Round	S	Standard
		RM	Remodel			F	Fire Rated
		CP	Chicago Plenum ¹				
		LT	Low Profile TRIAC (3" Plenum)				
		LO	Low Profile 0-10V (3" Plenum)				

DRD MODULE

PRODUCT CODE		LUMENS		CRI		CCT		BEAM SPREAD		DIMMING	
<input type="text"/>		<input type="text"/>		<input type="text"/>		<input type="text"/>		<input type="text"/>		<input type="text"/>	
DRD2M	Fixed	04	400 lm	S	Specialty	TF	Turtle Friendly	GA	General Ambient (90°+)	T	TRIAC/ELV
								NS	Narrow Spot (15°)	O	0-10V
								SP	Spot (25°)		
								FL	Flood (40°)		
								WF	Wide Flood (60°)		
								LS	Linear Spread		
								SF	Soft Focus		

M SERIES TRIM

PRODUCT CODE		SHAPE		STYLE		FINISH		OPTION	
<input type="text"/>		<input type="text"/>		<input type="text"/>		<input type="text"/>		<input type="text"/>	
M4T	4" Trim	R	Round	S	Beveled	WH	White	[Blank]	None
				H	Hyperbolic ²	BK	Black	FL	Flangeless ^{2,5}
				P	Pinhole ²	BZ	Bronze	DF	Dead Front ^{3,4}
				L	Lensed Wall Wash	CW	Clear Diffused, White Flanged		
				C	Square Conversion ³	WW	Warm Diffused, White Flanged		
						CC	Custom Color		

M4XRMUD	Flangeless Mud Plate (Required for Flangeless Trim drywall installation)
----------------	--

¹ Only available in Standard rating

² Only available in White, Black, Bronze or Custom Color finish

³ Only available in White or Custom Color finish

⁴ Only available in Beveled style

⁵ Not available for Square Conversion



PRODUCT BUILDER

OPTICS ACCESSORIES

PRODUCT CODE	
<input type="text"/>	
DRD2X-GA	Fixed Conversion Kit: DRD2 Module to General Ambient (90°+)
DRD2X-NS	Fixed Narrow Spot (15°)
DRD2X-SP	Fixed Spot (25°)
DRD2X-FL	Fixed Flood (40°)
DRD2X-WF	Fixed Wide Flood (60°)
DRD2X-LS	Fixed Linear Spread (40° x 20°)
DRD2X-SF	Fixed Soft Focus
DRD2X-OP	Fixed Optics Kit: Narrow Spot (15°), Spot (25°), Flood (40°), Wide Flood (60°), Linear Spread (40° x 20°), Soft Focus

MODULE

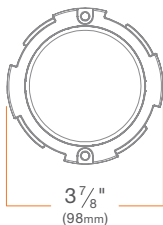
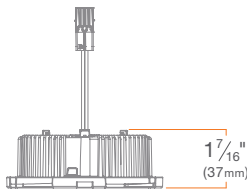

DRD2

Fixed Downlight

DRD2M

SUMMARY

LED CHIP: Cree® Red-Orange LED (no color filter)**DELIVERED MODULE LUMENS:** 400 lm (12W)**WAVELENGTH:** > 560 nm**BEAM SPREAD:** General Ambient (90°+), Narrow Spot (15°), Spot (25°), Flood (40°), Wide Flood (60°), Linear Spread (40° x 20°), Soft Focus**CONNECTOR:** PowerPlug® Luminaire Disconnect Model 182**INPUT VOLTAGE:** 120/277V, 50/60Hz**DIMMING:** Down to less than 1% for TRIAC/ELV at 120V, 0-10V or Lutron EcoSystem at 120/277V**MAX INPUT CURRENT (120V):** 0.090 amps, 0.107 amps**MAX INPUT CURRENT (277V):** 0.042 amps, 0.050 amps**POWER FACTOR:** Greater than 0.9**TOTAL HARMONIC DISTORTION:** Less than 20%**AMBIENT OPERATING TEMPERATURE:** -20°C to 40°C**PHOTOMETRIC TESTING:** Tested in accordance to IESNA LM-79-2008**LISTINGS:** UL Listed for Wet Location (flanged trims only), cULus Listed**LIFETIME:** 50,000 hours at 70% lumen maintenance**WARRANTY:** 5 year limited warranty

HOUSING



M Series

New Construction

SUMMARY

JUNCTION BOX: Equipped with 10 knockouts: two 1/2" and two 3/4" trade size knockouts on top, two 1/2" trade size knockouts on side, four romex knockouts on top. Approved for 8 (four in, four out) #12 AWG 70°C.

MOUNTING: Pre-installed mounting brackets allow vertical adjustment of bar hangers up to 1 1/4".

CEILING: 1/2" up to 1 3/4"

CUTOUT: 4" (102mm) round opening

LISTINGS: Metallic outlet box certified UL514A, code compliant for use in appropriate fire-rated assemblies for up to 2-hours (Fire Rated only), STC/IIC Sound Rated, ASTM E283 certified Air Tight, IC (Insulation Contact) rated

WARRANTY: 5 year limited warranty

New Construction

- M4NCRS (Standard)
- M4NCRF (Fire Rated)
- M4CPRS (Chicago Plenum)

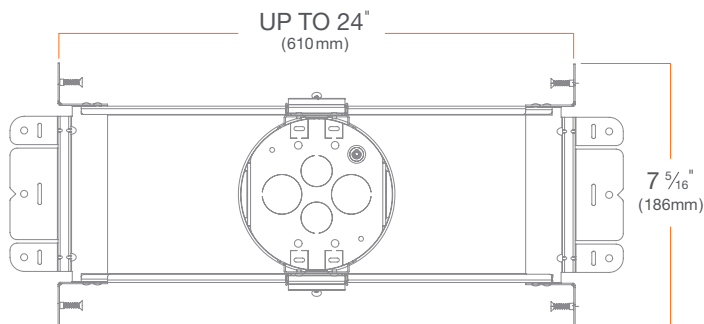
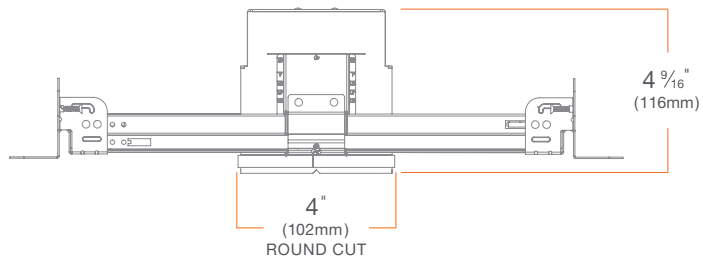

Low-Profile

- M4LTRS (Standard, TRIAC/ELV)
- M4LTRF (Fire Rated, TRIAC/ELV)
- M4LORS (Standard, 0-10V)
- M4LORF (Fire Rated, 0-10V)

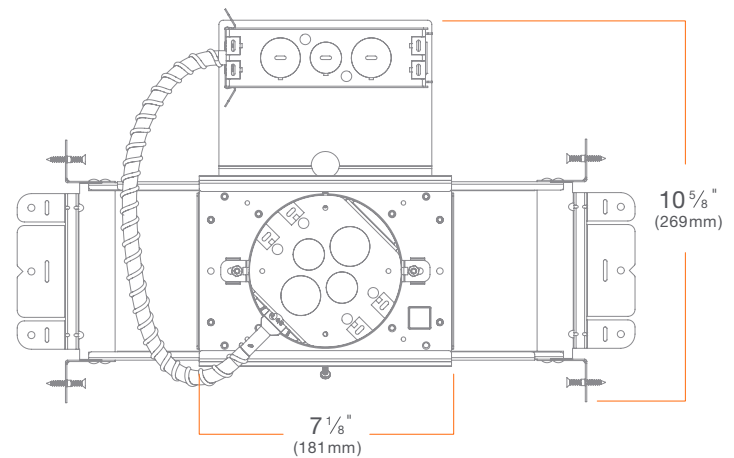
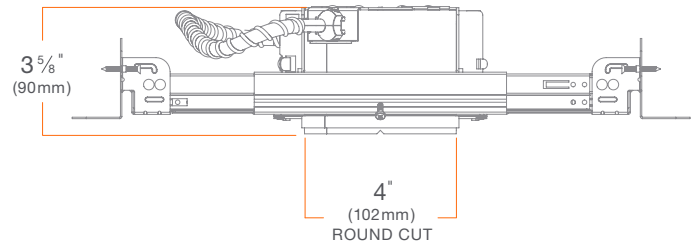

HOUSING



M Series

Remodel

M4RMRS (Standard)

M4RMRF (Fire Rated)

SUMMARY

JUNCTION BOX: Equipped with 8 knockouts: two 1/2" and two 3/4" trade size knockouts on top, four romex knockouts on top. Approved for 8 (four in, four out) #12 AWG 70°C.

MOUNTING: Pre-installed mounting spring clips

CEILING: 5/8" up to 1 1/4"

CUTOUT: 4 1/4" (108mm) round opening

LISTINGS: Metallic outlet box certified UL514A, code compliant for use in appropriate fire-rated assemblies for up to 2-hours (Fire Rated only), STC/IIC Sound Rated, ASTM E283 certified Air Tight, IC (Insulation Contact) rated

WARRANTY: 5 year limited warranty

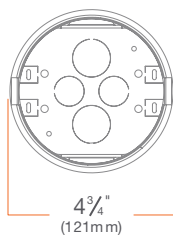
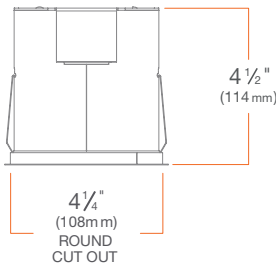

TRIMS

M Series

4" Round Trims

M4TR

SUMMARY

CONSTRUCTION: Die-cast aluminum

INSTALLATION: Twist & Lock

Beveled Trim

M4TRSWH

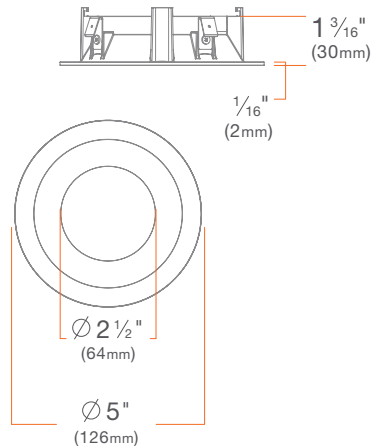

Square Conversion Trim

M4TRCWH

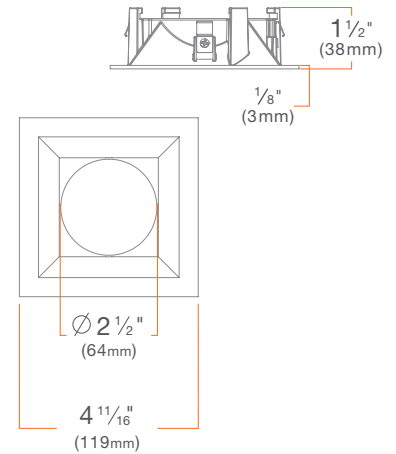

Hyperbolic Trim

M4TRHWH

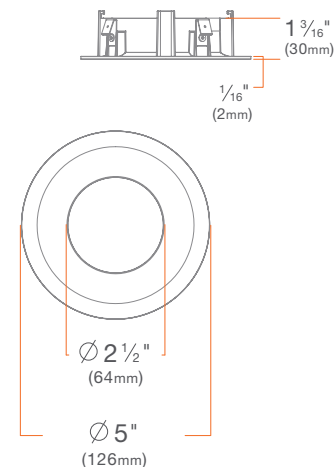

Pinhole Trim

M4TRPWH

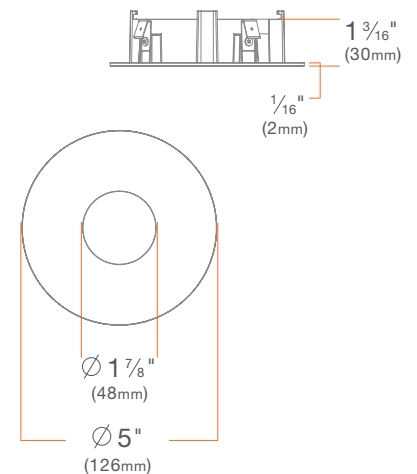
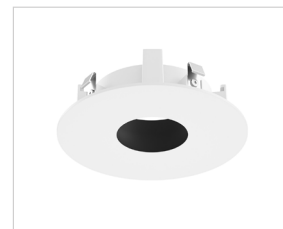

Wall Wash Trim

M4TRLWH

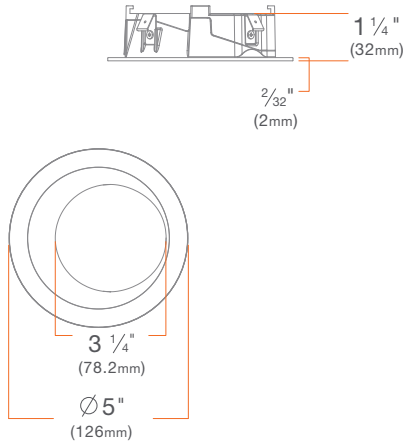

Hyperbolic Flangeless Trim Insert

M4TRHWHFL

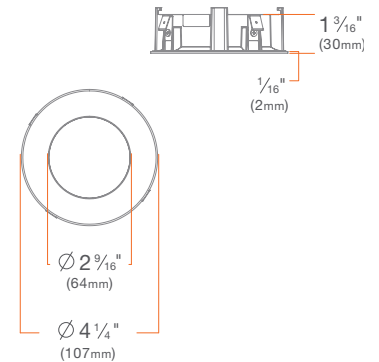

Pinhole Flangeless Trim Insert

M4TRPWHFL

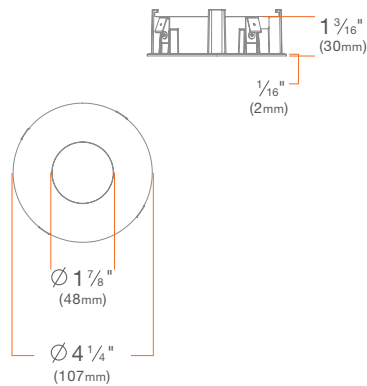

Wall Wash Flangeless Trim

M4TRLWHFL

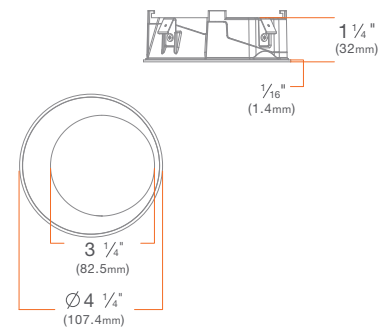

Beveled Flangeless Trim Insert

M4TRSWHFL

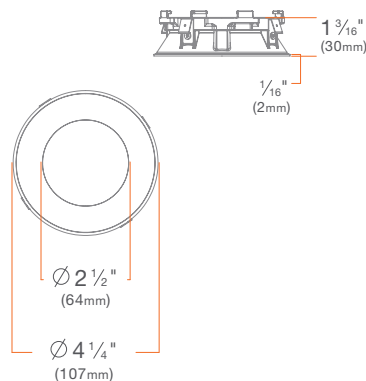

Flangeless Mud Plate

M4XRMUD



PHOTOMETRY

DRD2M04STFGAx

